



Introducing **Mirage Activa™** nasal mask
with **ActiveCell™** Technology

RESMED



Sleep is active

Did you know that the average sleeping person moves around six times per hour, and up to fifty times every night?!

Although movement during sleep is quite normal, it can affect mask position and seal for people on positive airway pressure therapy. However, movement is not the only variable in active sleep.

Many factors make sleep active

Continual changes in mask position, facial muscle tone, headgear strap tension, and therapy pressure, all make sleep very "active."

Active sleep demands active seal

These variables are difficult and often impossible to estimate during mask fitting. Yet, they may affect seal and result in mask leak, compromising therapy effectiveness as well as patient comfort and compliance.

Mirage Activa™—the first nasal mask with ActiveCell Technology

- **Active seal**—dynamic seal and leak control during active sleep, all night long.
- **Auto-stabilizing**—air-filled suspension keeps the cushion in place, even when various forces pull or push the mask frame in different directions.
- **Improved comfort**—due to reduced headgear strap tension.
- **Easier fitting**—due to less dependence on headgear strap tension.

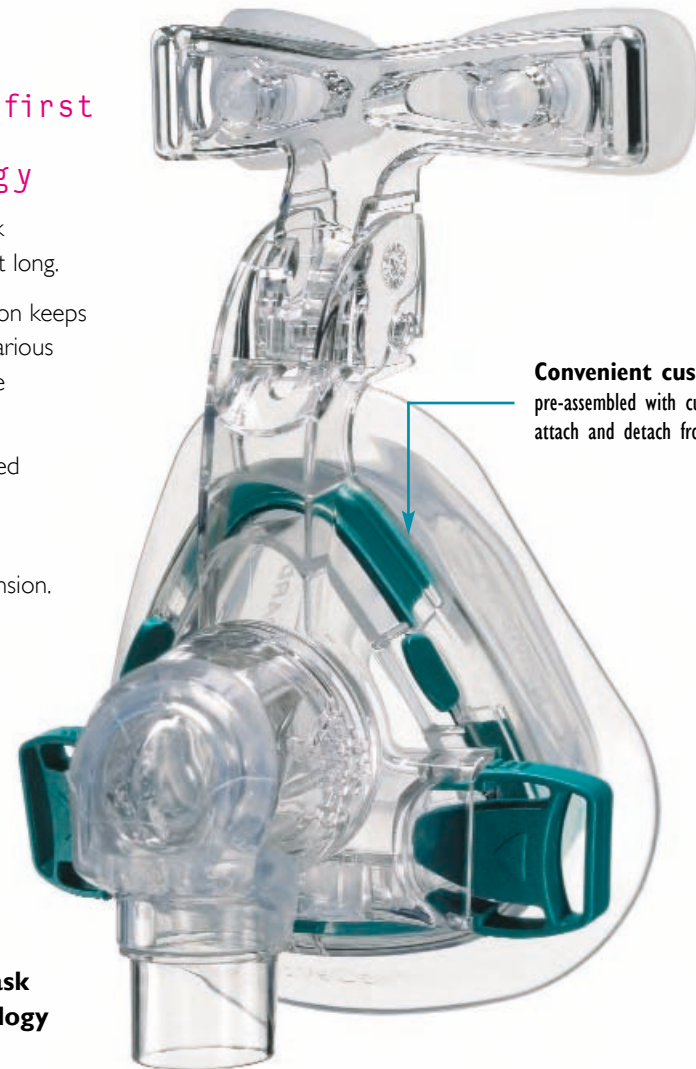

Convenient cushion clip—pre-assembled with cushion, easy to attach and detach from mask frame.

Mirage Activa nasal mask with ActiveCell technology



Mirage Activa—fit easily, recommend confidently

Fitting Mirage Activa is easy, as the ActiveCell minimizes the need to depend on headgear strap tension. This means you spend less time adjusting the head gear and forehead support.

When you send your patient home with a Mirage Activa, you have the assurance of knowing that ActiveCell Technology will automatically respond and adapt to changing conditions.

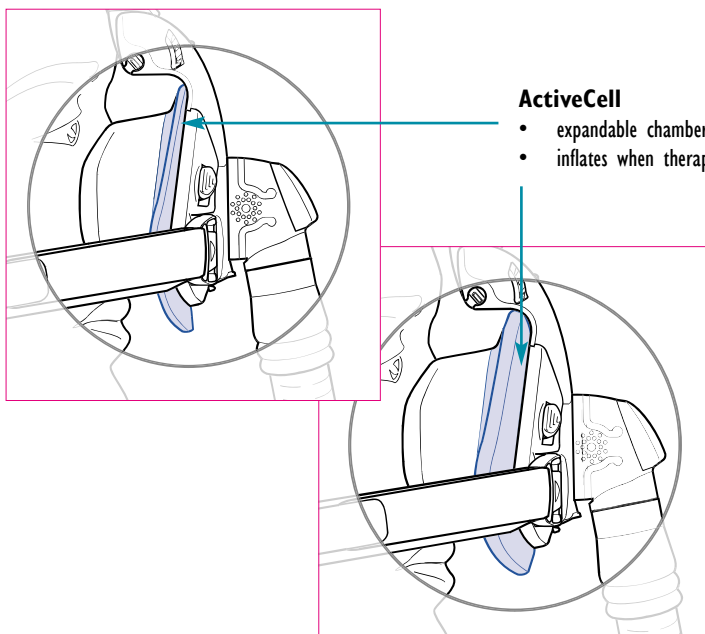

- ActiveCell**
- expandable chamber
 - inflates when therapy starts



One Snap Elbow—allows quick and easy removal of the air tube while the mask is still on the face.



Adjustable forehead support—with four position options to optimize seal and increase stability.



Flexible forehead pads—conform to the contour of the patient's forehead.



Quick release headgear clips—for added convenience.



Mirage Activa—patient benefits

Mirage Activa with ActiveCell Technology offers practical benefits for patients.

More choice of head and body positions during active sleep

Mirage Activa is so adaptable, it maintains seal even when patients roll over during sleep, or rest their head in the middle of the pillow rather than on the edge.

More comfort

Mirage Activa's unique technology helps reduce headgear strap tension and minimizes leak, providing more comfort for patients.

Set & Forget convenience

ActiveCell Technology also compensates for changes in strap tension, eliminating the need for continual adjustment of headgear straps.

Reduced eye irritation and facial marks

Mirage Activa is kind to the eyes and facial skin. Lower headgear strap tension minimizes the appearance of unsightly marks on the face. Reduced leak helps minimize eye irritation.

Fewer leak-induced arousals

This may lead to better quality of sleep.

Mirage Activa—professional benefits

Mirage Activa with ActiveCell Technology provides unique advantages to sleep health professionals.

Improve efficiencies

- **Reduce fitting time**
Mirage Activa can help cut down on fitting time and may even help achieve accurate first-time fit. This is possible because ActiveCell Technology is less dependent on headgear strap tension to achieve an effective seal.
- **Reduce patient management costs**
Improved comfort and therapy acceptance minimize the need for call-backs and returns.

See the results for yourself

- **Improve patient compliance**
Increased comfort and leak control can help optimize patient compliance.
- **Recommend with confidence**
Now there is a mask you can confidently choose to minimize mask leak and associated problems.

...because active sleep demands an active seal

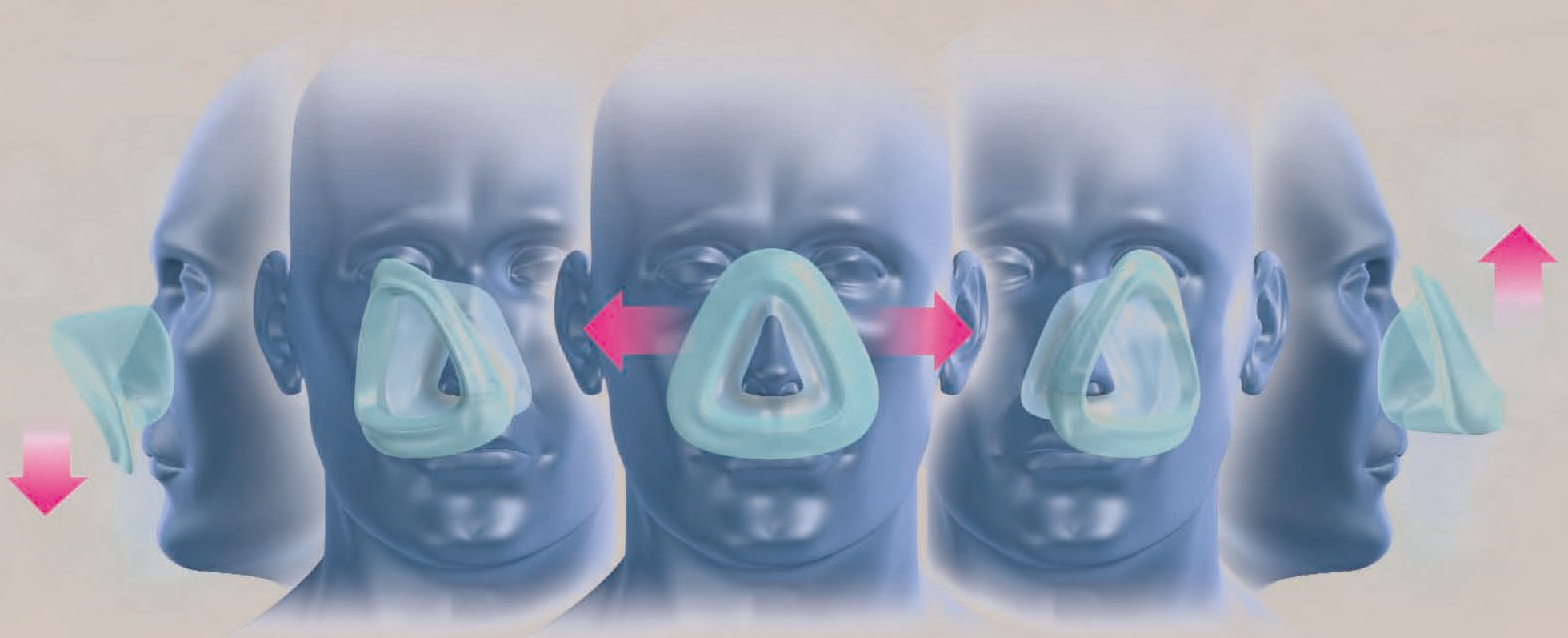

ActiveCell™ Technology allows the mask frame to move independently of the mask cushion. This helps the cushion stay in place and maintain seal during active sleep.

ResMed introduces ActiveCell™ Technology

ActiveCell Technology is ResMed's exclusive, auto-stabilizing cushion technology.

ActiveCell Technology combines the proven comfort and seal of Mirage® cushion technology with an "active cell"—an inflatable chamber which expands and contracts during therapy. Together, they provide a unique, active seal and a dynamic defense against mask leak.

The air-filled chamber functions as an independent suspension, adapting to the forces created by movement and other changes during sleep. It automatically, continuously and actively compensates for such forces, no matter which direction they come from.

ActiveCell Technology maintains an active seal and a dynamic defense against leaks.

Mirage Activa with ActiveCell Technology —proof of superior seal

The ability of the Mirage Activa to provide superior seal and comfort is supported by the results of independent clinical studies.

- **Superior seal with less headgear tension**

A study of 20 continuous positive airway pressure (CPAP) patients has demonstrated that the Mirage Activa provides superior seal compared with other mask brands. The Mirage Activa maintained superior seal despite the headgear tension being considerably less, on average, than the other masks. The study concluded that these differences may have a positive impact on patient comfort and sleep quality when using CPAP.²

- **Maintains seal despite changes in headgear strap tension, strap length and mask position**

Another study conducted on 20 patients found that the Mirage Activa achieved significantly better seal than a standard nasal mask when subjected to changes in headgear strap tension and length. It was also able to maintain better mask seal during lateral displacement / side-to-side movement.³

- **Reduced side effects**

Another study was based on 17 patients who reported problems with their existing mask. After using the Mirage Activa for 3 months, these patients had a significant decrease in facial marks, conjunctivitis, and awakenings caused by mask discomfort or leaks.⁴

References

¹ Lu et al. *Physiol. Meas.* 1999; 20: 137-148.

² Smith et al. *Sleep* 2003; 26(Sup.) A: 406-407.

³ Philippe C. & Baud L. A. *Sleep Medicine* 2003; 4(Sup. 1): 165.

⁴ Philippe C. et al. *Sleep Medicine* 2003; 4(Sup. 1): 166.



RESMED

Waking people up to sleep

Mirage Activa System Product Codes

USA, Canada, and South America

Mirage Activa Mask System	Standard	60100
Mirage Activa Mask System	Large	60101
Mirage Activa Mask System	Shallow	60102

Europe (except UK) and Asia Pacific

Mirage Activa Mask System	Standard	60103
Mirage Activa Mask System	Large	60104
Mirage Activa Mask System	Shallow	60105

UK

Mirage Activa Mask System	Standard	60132
Mirage Activa Mask System	Large	60133
Mirage Activa Mask System	Shallow	60134

Medicare reimbursement codes (USA)

HCPSC Code	Descriptor
A7032	Replacement cushion for nasal application device (each)
A7034	Nasal application device with PAP device (each)
A7035	Headgear with PAP device

ResMed Corp Poway, CA, USA +1 858 746 2400 OR 1 800 424 0737 (toll free), ResMed Ltd Bella Vista, NSW, Australia +61 (2) 8884 1000 or 1 800 658 189 (toll free). Offices in Austria, Finland, France, Germany, Japan, Malaysia, Netherlands, New Zealand, Singapore, Spain, Sweden, Switzerland, United Kingdom (see web site for details). www.resmed.com

Protected by patents: AU 710733, AU 712236, AU 724360, AU 741003, AU 766623, AU 775051, DE 29724224, NZ 513052, NZ 526165, US 6112746, US 6357441, US 6374826, US 6439230, US 6463931, US 6532961, US 6561190, US 6561191, US 6634358, US 6772760. Others pending. Protected by design registrations: DE 40301991, FR 03 1388, FR 03 1389, FR 03 1425, FR 03 1426, FR 03 1427, FR 03 1428, FR 03 1429, FR 03 1430, JP 1192858, JP 1192859, JP 1192860, JP 1197930, JP 1200876, JP 1201592, JP 1211086, JP 1211126, JP 1211264, JP 1212509, JP 1212835, JP 1214810, NZ 513052, US D486226, US D486227, US D486907, US D487510, US D490343, US D492992, US D493521, US D493522, US D494675, US D495797, US D496098, US D496726. Others pending. Mirage and Activa are trademarks of ResMed Ltd. © 2004 ResMed Ltd. 1010010/2 04 11